



Safety Flow Meter S-SM 3-1

Certain applications in fluid and gas analysis require additional safety precautions, including flow meters. Here it's particularly important to protect the clear measuring tube from mechanical damage. In this series a solid, slotted stainless steel protective tube ensures this protection.

Even with the measuring tube already having a thick wall, the stainless steel casing of course also protects the surroundings in the event a glass cylinder bursts.

Robust, simple protection

Large range of applications

High safety standard

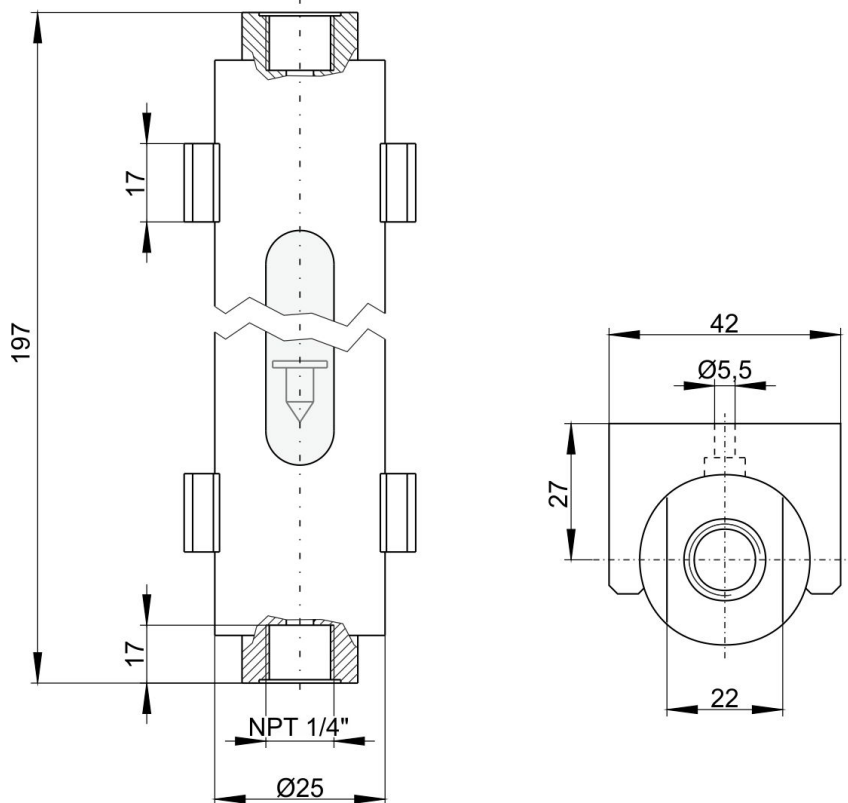

Flow meter dimensions

**Use in explosive areas (additional notices):**

The flow meter meets the fundamental safety requirements of Directive 2014/34/EU and is suitable for use in zone 1, explosion group IIC. The flow meter is not marked, as it does not have an innate ignition source and Directive 2014/34/EU therefore does not apply.

Be sure to observe the instructions in the respective operating instructions!

Technical Data**Safety Flow Meter S-SM 3-1**

| | |
|------------------------|---|
| Ambient temperature: | -20 °C to 80 °C * |
| Operating pressure: | 10 bar (at max. 20 °C) ** |
| Operating temperature: | 100 °C (at max. 2 bar) ** |
| Measuring range: | see table |
| Weight: | 0.9 kg |
| Float: | glass, Hastelloy, stainless steel or PTFE |
| End sections: | PTFE, stainless steel or titanium |
| Mounting: | via included pipe clamps |

* specify in order, select mounting.

** Max. operating pressure [bar] = $10 - \frac{\text{Max. operating temperature [°C]} - 20}{10}$

Typical measuring ranges

| Flow Meter S-SM 3-1 | | |
|---------------------|----------------|----------------|
| Medium: | Air | Water |
| Pressure: | + 1.2 bar abs. | |
| Temperature: | + 20 °C | + 20 °C |
| | 1.6 – 16 NI/h | 0.25 - 2.5 l/h |
| | 4 – 40 NI/h | 0.5 - 5 l/h |
| | 6 - 60 NI/h | 1.2 - 12 l/h |
| | 10 – 100 NI/h | 2.5 - 25 l/h |
| | 25 – 250 NI/h | 4 - 40 l/h |
| | 50 – 500 NI/h | 6 - 60 l/h |
| | 80 – 800 NI/h | 10 - 100 l/h |

Spare parts and accessories

| Item no. | Description | |
|-----------|---------------------|-------------------------------------|
| 40 22 999 | Flow Meter S-SM 3-1 | End sections stainless steel 1.4571 |
| 40 23 999 | Flow Meter S-SM 3-1 | End sections titanium |

Axis Solutions Pvt Ltd is the Authorized Distributor of Bühler Technologies GmbH in India
www.axisindia.in | info@axisindia.in